

Corridor Redevelopment



56



Overall Corridor Opportunities



57



Overall Corridor Opportunities > Triple Greenbelt Concept

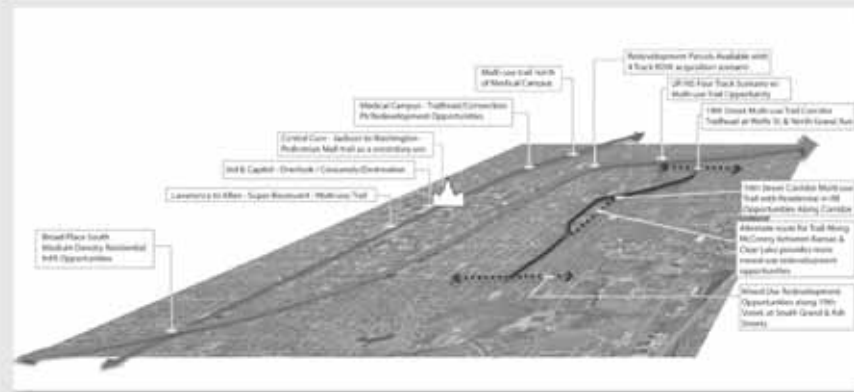

Overall Corridor Opportunities Map



Overall Corridor Opportunities > Existing Trails/Park Space & Potential Trails/Park Space

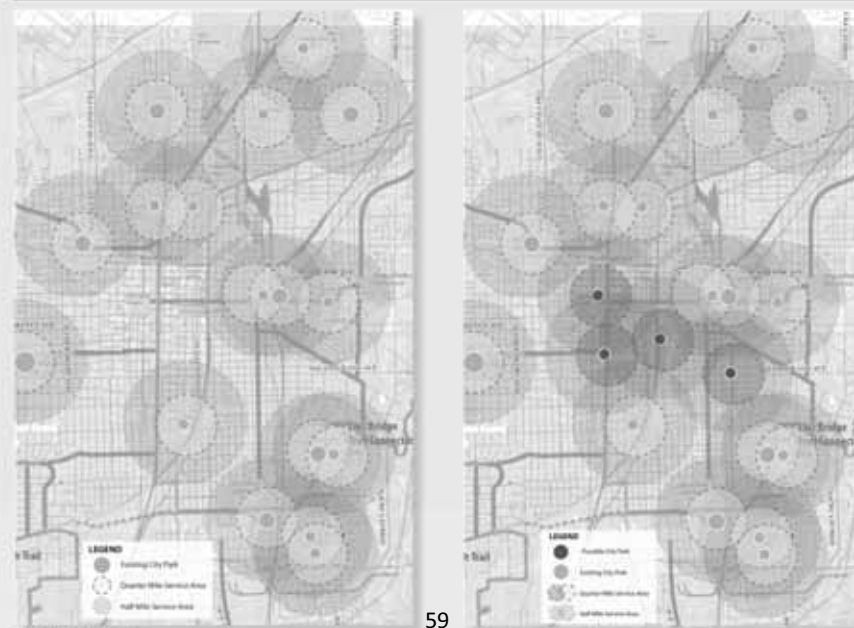

Existing Trails & Park Map

Potential Trails & Park Map

3rd Street Corridor Opportunities



60



3rd Street Corridor > Residential Infill Opportunity

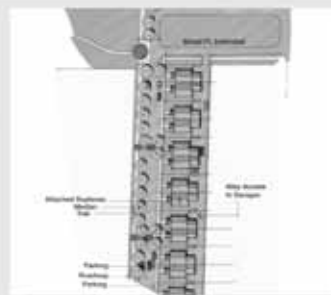
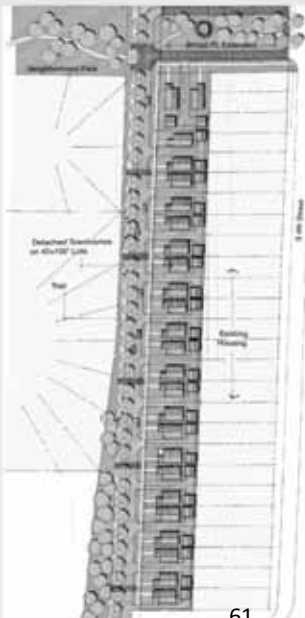

- Extend Broad Place
- Convert Rail to Trail
- In-fill with Townhomes or Duplexes
- Connect new trail with existing trails/bike routes and parks



61



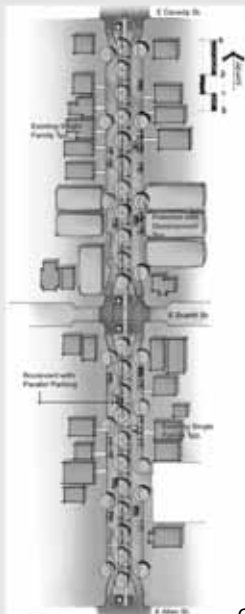

- Convert Rail to Trail in oversized median of roadway.
- In-fill vacant lots with single family homes.
- Provide on-street parking.
- Enhance intersections to provide priority for the trail users and pedestrians.



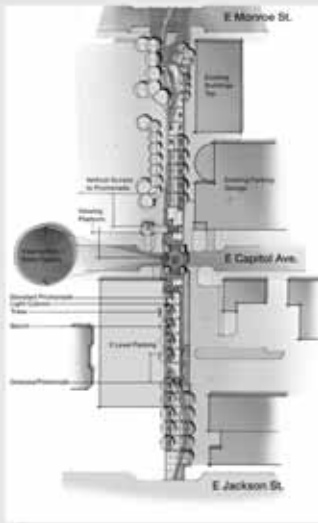

The High Line Park - New York City



The High Line Park - New York City



3rd Street Corridor > Connecting to Capitol Avenue



3rd Street Corridor > The Capitol Landing

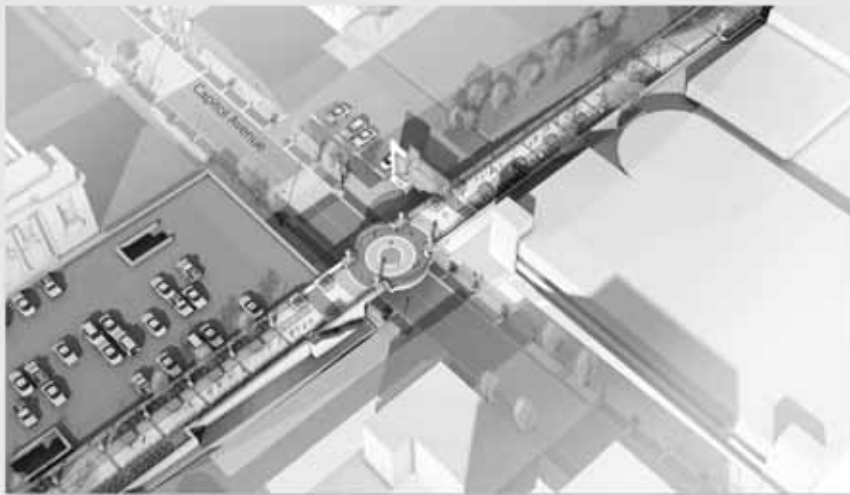

Capitol Landing birds-eye perspective



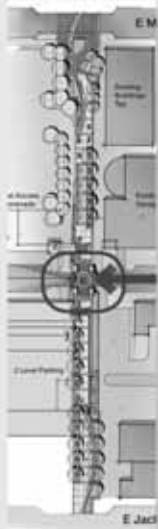

Capitol Landing from Capitol Avenue

- Rebuilt overpass to open up views and celebrate Capitol building
- Connection to greenbelt and Capitol Avenue
- Complimentary materials used to build visual connections



68

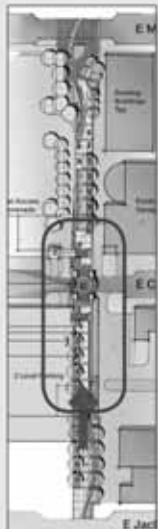

Capitol Landing from 3rd Street Corridor - looking north

- Pedestrian focused trail.
- Re-use of abandoned rail materials for various built features.
- Built features that harken to the corridors railroad origins.



69

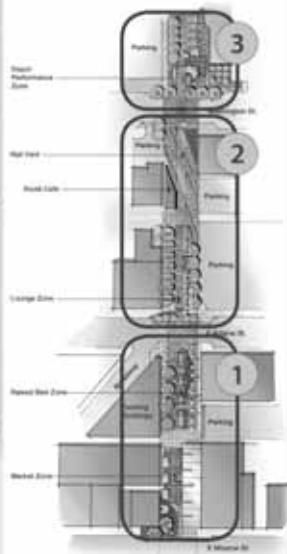

- Pedestrian centric linear park and market.
- Create entertainment district downtown
- Linear connection with rest of trail system



70

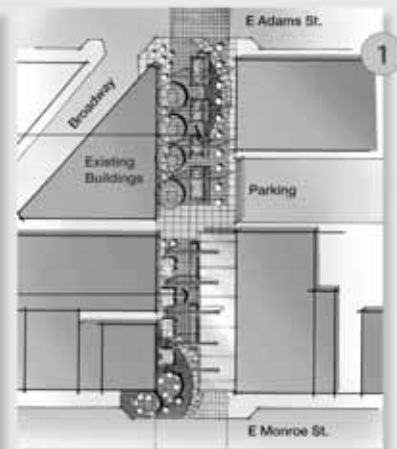
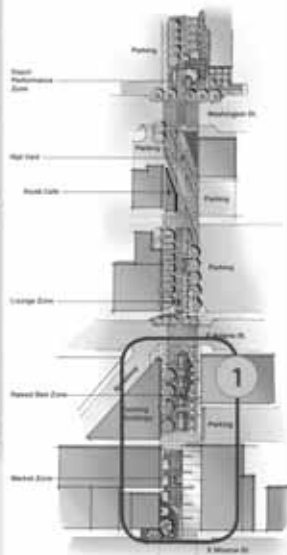

71



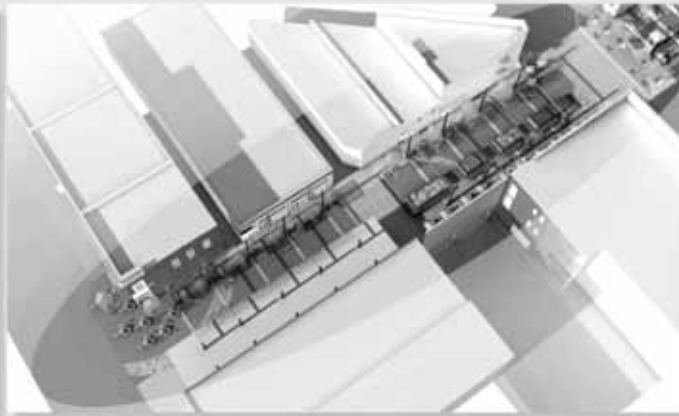
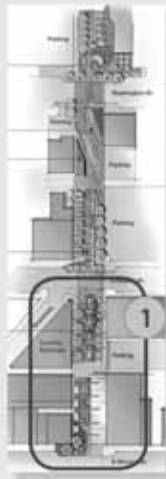

- Market zone to promote local businesses.
- The Gardens provide a green oasis within the urban context.



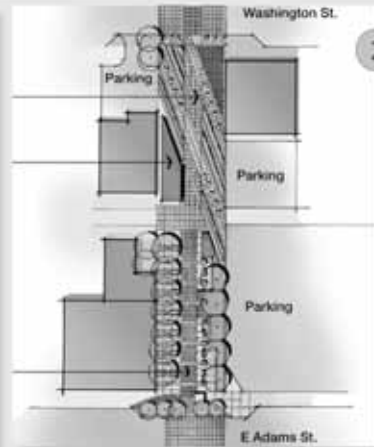
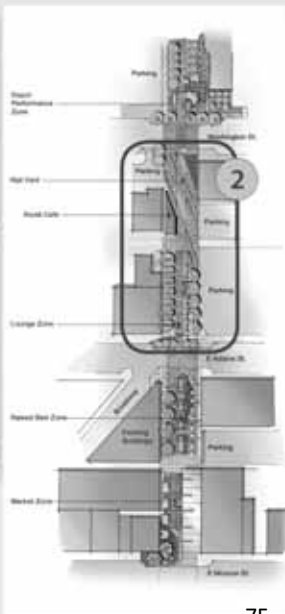

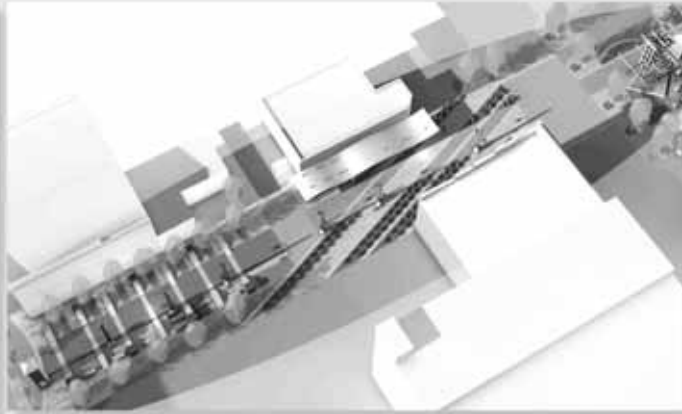
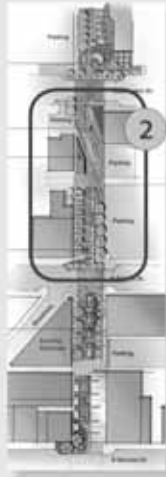

- The Lounge Zone creates a resting spot and area for small gatherings.
- The Railyard provides a small cafe-like opportunity within the pedestrian mall.



76



77



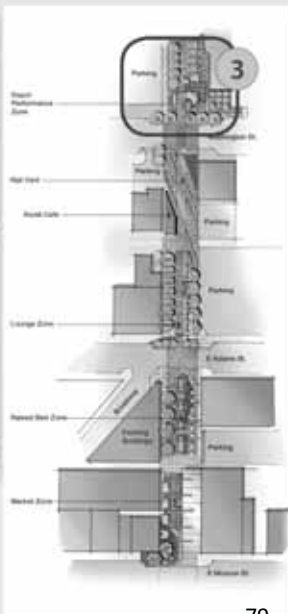



- Adaptive reuse of the Depot provides opportunities for dining, small concerts and a meeting place.



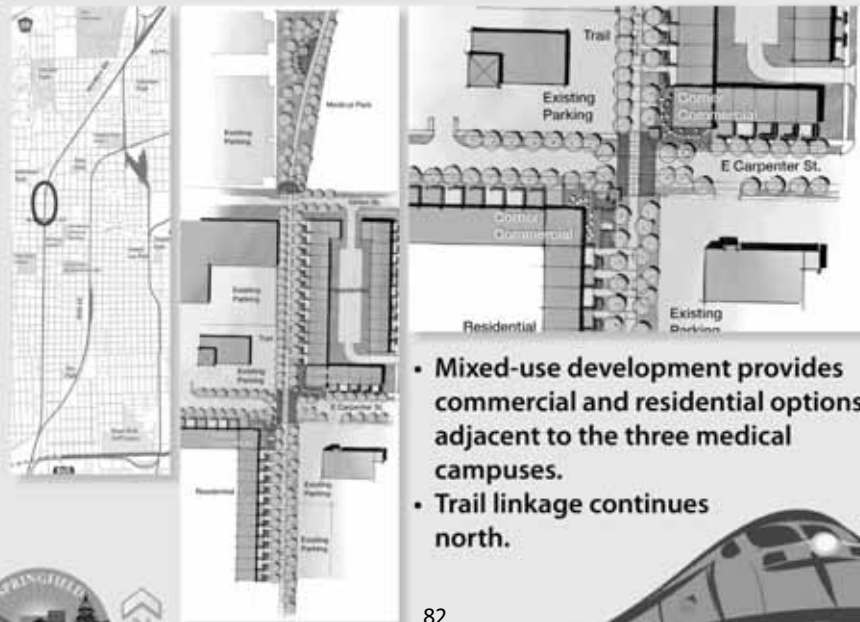

82



83

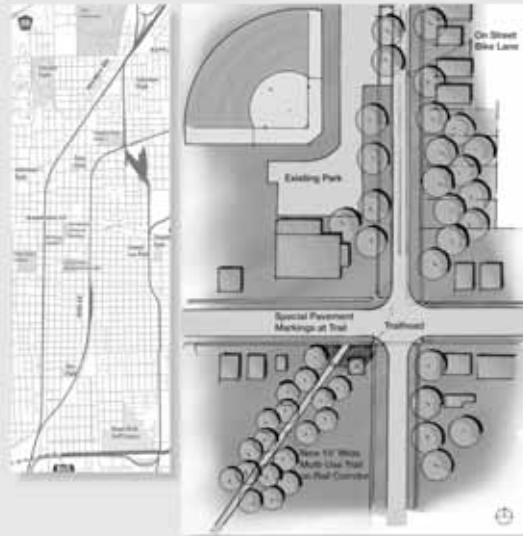

- Multi-use trail continues north.
- Trail becomes bike lane on existing roadways at Eastman & 8th.
- Trail connects to the Illinois State Fairgrounds.



10th Street Corridor Opportunities



86



10th Street Corridor Opportunities > Mixed Use Redevelopment Concept



- Opportunities for mixed-use development occur in areas near the downtown along rail corridor.
- 50 foot greenbelt adjacent to rail corridor provides multi-use trail and linkages north and south through Springfield.





Trail bridges
at overpasses
eliminate conflicts
between trail
users and vehicles.





- Opportunities for medium density residential occur in areas north and south of downtown along rail corridor.
- 50 foot greenbelt adjacent to rail corridor provides multi-use trail and linkages north and south through Springfield.





19th Street Corridor Opportunities





- Opportunities for single family in-fill development occur all along the 19th Street corridor.
- Unique lot layout may help create a dynamic neighborhood and promote a strong sense of community.



- Trail corridor running north and south provides a strong linkage along the 19th Street corridor.





Questions / Comments

